

DiC TOOLS

A Brand by Dedicated Impex Co.



ROUND & HEX THREADING DIES

*We can Manufacture Customized Round & Hex Dies as
Per Customer Requirement.*

Round & Hex Threading Dies**Page No. (03-37)**

Metric Coarse Threads	03-04
Metric Fine Threads	05-08
Whitworth Coarse Threads	09-10
Whitworth Fine Threads	11-12
British Association Threads	13
British Brass Threads	14
Model Engineer Threads	15
Whitworth Fine Special Threads	16
British Standard Pipe Threads	17
British Standard Taper Pipe Threads	18
Unified Coarse Threads	19-20
Unified Fine Threads	21-22
National Taper Pipe Threads	23
Metric Coarse Threads	24
Metric Fine Threads	25-26
Metric Coarse Threads	27-28
Metric Fine Threads	29
Whitworth Coarse Threads	30
Whitworth Fine Threads	31
British Standard Pipe Threads	32
British Standard Taper Pipe Threads	33
Unified Coarse Threads	34
Unified Fine Threads	35
National Taper Pipe Threads	36

Metric Coarse Threads

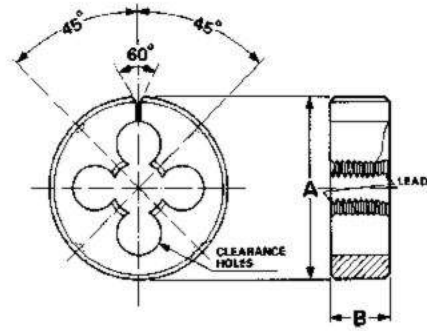

ROUND SPLIT DIES

CARBON STEEL

HSS

HSS

CS

BS
1127

6G

Unit : mm

Nominal Diameter	Pitch	Outer Diameter	Thickness	Clearance Holes	Threading Diameter
Ø D	p	A	B		
M 2	0.4	13/16"	1/4"	3	1.96
M 3	0.5	13/16"	1/4"	3	2.95
M 4	0.7	13/16"	1/4"	3	3.95
M 5	0.8	13/16"	1/4"	3	4.95
M 6	1	13/16"	1/4"	4	5.93
M 7	1	13/16"	1/4"	4	6.93
M 6	1	1"	3/8"	4	5.93
M 7	1	1"	3/8"	4	6.93
M 8	1.25	1"	3/8"	4	7.92
M 9	1.25	1"	3/8"	4	8.93
M 10	1.5	1"	3/8"	4	9.91
M 12	1.75	1.1/2"	1/2"	4	11.90
M 14	2	1.1/2"	1/2"	5	13.89
M 16	2	1.1/2"	1/2"	5	15.89
M 18	2.5	1.1/2"	1/2"	6	17.88
M 20	2.5	1.1/2"	1/2"	6	19.88

Metric Coarse Threads

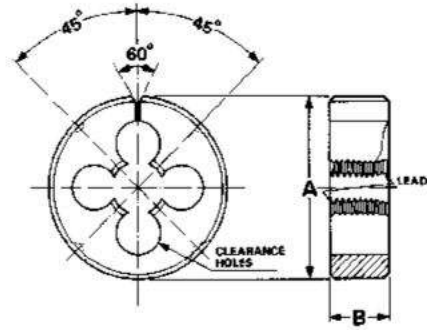

ROUND SPLIT DIES

CARBON STEEL

HSS

HSS

CS

BS
1127

6G

Unit : mm

Nominal Diameter	Pitch	Outer Diameter	Thickness	Clearance Holes	Threading Diameter
ØD	p	A	B		
M 20	2.5	2"	5/8"	5	19.88
M 22	2.5	2"	5/8"	5	21.88
M 24	3	2"	5/8"	5	23.88
M 27	3	2.1/4"	11/16"	6	
M 30	3.5	2.1/4"	11/16"	6	
M 33	3.5	2.1/4"	11/16"	6	
M 36	4	2.1/2"	7/8"	6	
M 36	4	3"	7/8"	6	
M 39	4	3"	7/8"	6	
M 42	4.5	3"	7/8"	6	
M 48	5	4"	1"	6	

Metric Fine Threads

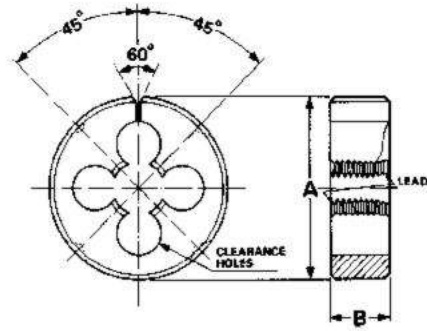

ROUND SPLIT DIES

CARBON STEEL

HSS

HSS

CS

**BS
1127**

6G

Unit : mm

Nominal Diameter	Pitch	Outer Diameter	Thickness	No. Clearance Hole	Threading Diameter
Ø D	p	A	B		
M 1.6	0.35	13/16"	1/4"	3	1.56
M 2.2	0.45	13/16"	1/4"	3	2.15
M 2.3	0.4	13/16"	1/4"	3	2.25
M 2.5	0.45	13/16"	1/4"	3	2.45
M 2.6	0.45	13/16"	1/4"	3	2.55
M 3	0.6	13/16"	1/4"	3	2.96
M 3.5	0.6	13/16"	1/4"	3	3.46
M 4	0.5	13/16"	1/4"	3	3.95
M 4	0.75	13/16"	1/4"	3	3.95
M 4.5	0.5	13/16"	1/4"	3	4.45
M 4.5	0.75	13/16"	1/4"	3	4.45
M 5	0.5	13/16"	1/4"	3	4.95
M 5	0.75	13/16"	1/4"	3	4.95
M 5	0.9	13/16"	1/4"	3	4.95
M 5.5	0.5	13/16"	1/4"	4	5.45
M 5.5	0.9	13/16"	1/4"	4	5.45
M 6	0.5	13/16"	1/4"	4	5.95
M 6	0.75	13/16"	1/4"	4	5.95
M 7	0.75	13/16"	1/4"	4	6.95



Metric Fine Threads

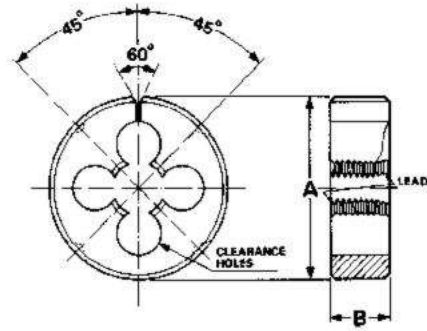

ROUND SPLIT DIES

CARBON STEEL

HSS

HSS

CS

**BS
1127**

6G

Unit : mm

Nominal Diameter	Pitch	Outer Diameter	Thickness	No. Clearance Hole	Threading Diameter
Ø D	p	A	B		
M 6	0.5	1"	3/8"	4	5.95
M 6	0.75	1"	3/8"	4	5.95
M 7	0.75	1"	3/8"	4	6.95
M 8	0.75	1"	3/8"	4	7.97
M 8	1	1"	3/8"	4	7.93
M 9	0.75	1"	3/8"	4	8.95
M 9	1	1"	3/8"	4	8.93
M 10	0.5	1"	3/8"	4	9.93
M 10	0.75	1"	3/8"	4	9.95
M 10	1	1"	3/8"	4	9.93
M 10	1.25	1"	3/8"	4	9.93
M 11	1	1.1/2"	1/2"	5	10.93
M 11	1.5	1.1/2"	1/2"	4	10.91
M 12	1	1.1/2"	1/2"	5	11.93
M 12	1.25	1.1/2"	1/2"	5	11.92
M 12	1.5	1.1/2"	1/2"	4	11.91
M 14	1	1.1/2"	1/2"	5	13.93
M 14	1.25	1.1/2"	1/2"	5	13.92



Metric Fine Threads

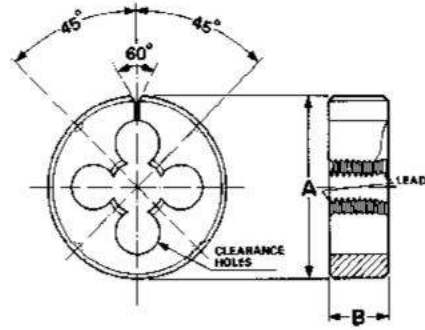

ROUND SPLIT DIES

CARBON STEEL

HSS

HSS

CS

**BS
1127**

6G

Unit : mm

Nominal Diameter	Pitch	Outer Diameter	Thickness	No. Clearance Hole	Threading Diameter
Ø D	p	A	B		
M 14	1.5	1.1/2"	1/2"	5	13.91
M 15	1.5	1.1/2"	1/2"	5	14.91
M 16	1	1.1/2"	1/2"	5	15.93
M 16	1.5	1.1/2"	1/2"	5	15.91
M 18	1.5	1.1/2"	1/2"	6	17.91
M 20	1.5	1.1/2"	1/2"	6	19.91
M 20	1.5	2"	5/8"	5	19.91
M 22	1.5	2"	5/8"	6	21.91
M 24	1	2"	5/8"	6	23.93
M 24	1.5	2"	5/8"	6	23.90
M 25	1.5	2"	5/8"	6	24.91
M 26	1.5	2"	5/8"	6	25.90
M 27	1.5	2"	5/8"	6+6	26.9
M 28	1.5	2"	5/8"	6+6	27.9
M 30	1.5	2"	5/8"	6+6	29.9
M 32	1.5	2.1/4"	11/16"	6+6	
M 33	1.5	2.1/4"	11/16"	6+6	



Metric Fine Threads

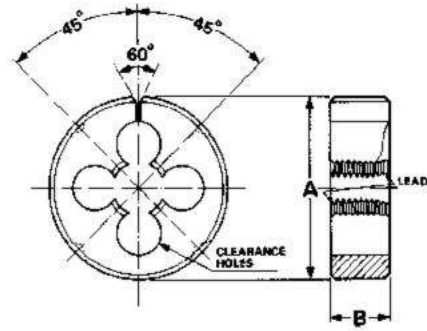

ROUND SPLIT DIES

CARBON STEEL

HSS

Unit : mm

HSS **CS** **BS 1127** **6G**

Nominal Diameter	Pitch	Outer Diameter	Thickness	No. Clearance Hole	Threading Diameter
Ø D	p	A	B		
M 34	1.5	2.1/2"	7/8"	6	
M 35	1.5	2.1/2"	7/8"	6	
M 36	1.5	2.1/2"	7/8"	6	
M 40	1.5	2.1/2"	7/8"	6	
M 34	1.5	3"	7/8"	6	
M 35	1.5	3"	7/8"	6	
M 36	1.5	3"	7/8"	6	
M 38	1.5	3"	7/8"	6	
M 45	1.5	3"	7/8"	6	
M 45	1.5	4"	1"	6	
M 46	1.5	4"	1"	6	
M 48	1.5	4"	1"	8	
M 50	1.5	4"	1"	6	
M 52	1.5	4"	1"	6	
M 55	1.5	4"	1"	6	
M 60	1.5	4"	1"	6	



Whitworth Coarse Threads

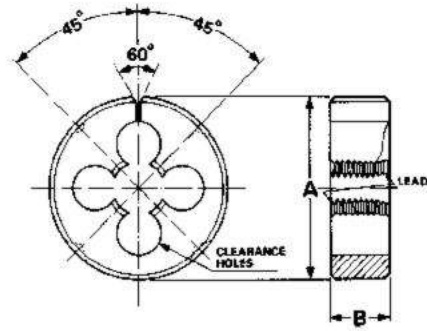

ROUND SPLIT DIES

CARBON STEEL

HSS

HSS

CS

BS
1127

6G

Unit : mm

Nominal Diameter	TPI	Outer Diameter	Thickness	No. Clearance Hole	Threading Diameter
Ø D		A	B		
1/16"	60	13/16"	1/4"	3	1.56
3/32"	48	13/16"	1/4"	3	2.35
1/8"	40	13/16"	1/4"	3	3.14
5/32"	32	13/16"	1/4"	3	3.93
3/16"	24	13/16"	1/4"	3	4.72
7/32"	24	13/16"	1/4"	4	5.51
1/4"	20	13/16"	1/4"	4	6.31
1/4"	20	1"	3/8"	3	6.31
9/32"	20	1"	3/8"	4	7.10
5/16"	18	1"	3/8"	4	7.88
3/8"	16	1"	3/8"	4	9.47
7/16"	14	1.1/2"	1/2"	4	11.05
1/2"	12	1.1/2"	1/2"	4	12.63
9/16"	12	1.1/2"	1/2"	5	14.21
5/8"	11	1.1/2"	1/2"	5	15.80
11/16"	11	1.1/2"	1/2"	6	17.39
3/4"	10	1.1/2"	1/2"	6	18.97



Whitworth Coarse Threads

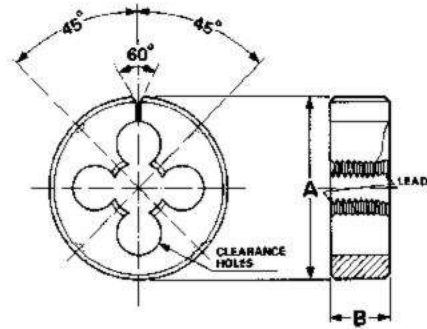

ROUND SPLIT DIES

CARBON STEEL

HSS

HSS **CS** **BS 1127** **6G**

Unit : mm

Nominal Diameter	TPI	Outer Diameter	Thickness	No. Clearance Hole	Threading Diameter
ØD		A	B		
7/8"	9	2"	5/8"	5	22.14
1"	8	2"	5/8"	6	25.30
1.1/8"	7	2.1/4"	11/16"	6	
1.1/4"	7	2.1/4"	11/16"	6	
1.1/4"	7	2.1/2"	7/8"	6	
1.3/8"	6	2.1/2"	7/8"	6	
1.1/2"	6	2.1/2"	7/8"	6	
1.1/2"	6	3"	7/8"	6	
1.3/4"	5	4"	1"	6	
2"	4.5	4"	1"	6	

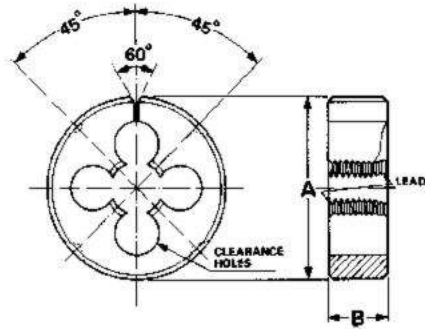

ROUND SPLIT DIES

CARBON STEEL

HSS

HSS **CS** **BS 1127** **6G**

Unit : mm

Nominal Diameter Ø D	TPI	Outer Diameter	Thickness	No. Clearance Hole	Threading Diameter
		A	B		
3/16"	32	13/16"	1/4"	3	4.73
7/32"	28	13/16"	1/4"	4	5.51
1/4"	26	13/16"	1/4"	4	6.31
1/4"	26	1"	3/8"	4	6.31
9/32"	26	1"	3/8"	4	7.1
5/16"	22	1"	3/8"	4	7.89
3/8"	20	1"	3/8"	4	9.47
7/16"	18	1.1/2"	1/2"	4	11.05
1/2"	16	1.1/2"	1/2"	4	12.63
9/16"	16	1.1/2"	1/2"	5	14.22
5/8"	14	1.1/2"	1/2"	5	15.80
3/4"	12	1.1/2"	1/2"	5	18.97
7/8"	11	2"	5/8"	5	22.14
1"	10	2"	5/8"	6	25.30
1.1/8"	9	2.1/4"	11/16"	6	

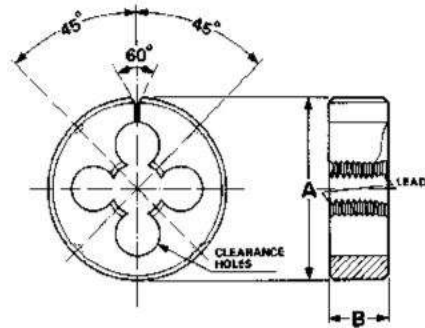

HSS
CS
BS 1127
6G

Unit : mm

Nominal Diameter	TPI	Outer Diameter	Thickness	No. Clearance Hole	Threading Diameter
ØD		A	B		
1.1/4"	9	2.1/4"	11/16"	6	
1.3/8"	8	2.1/2"	7/8"	6	
1.1/2"	8	2.1/2"	7/8"	6	
1.1/2"	8	3"	7/8"	6	
1.3/4"	7	4"	1"	6	
2"	7	4"	1"	6	

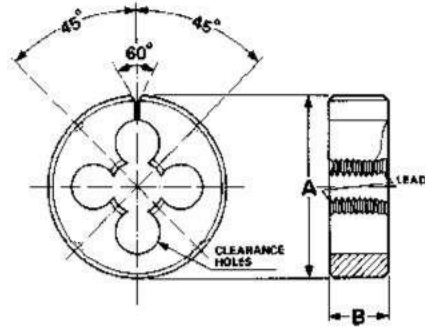

HSS

CS

BS
1127

6G

Unit : mm

Nominal Diameter	TPI	Outer Diameter	Thickness	No. Clearance Hole	Threading Diameter
Ø D		A	B		
# 12	90.9	13/16"	1/4"	3	1.27
# 11	81.9	13/16"	1/4"	3	1.47
# 10	72.6	13/16"	1/4"	3	1.67
# 9	65.1	13/16"	1/4"	3	1.87
# 8	59.1	13/16"	1/4"	3	2.16
# 7	52.9	13/16"	1/4"	3	2.46
# 6	47.9	13/16"	1/4"	3	2.76
# 5	43	13/16"	1/4"	3	3.15
# 4	38.5	13/16"	1/4"	3	3.55
# 3	34.8	13/16"	1/4"	3	4.04
# 2	31.4	13/16"	1/4"	3	4.64
# 1	28.2	13/16"	1/4"	4	5.23
# 0	25.4	13/16"	1/4"	4	5.92

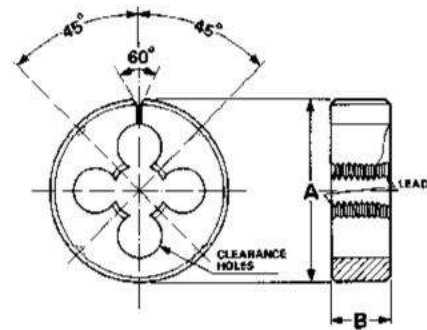

HSS

CS

BS
1127

6G

Unit : mm

Nominal Diameter	TPI	Outer Diameter	Thickness	No. Clearance Hole	Threading Diameter
ØD		A	B		
1/4"	26	13/16"	1/4"	4	6.31
1/4"	26	1"	3/8"	4	6.31
5/16"	26	1"	3/8"	4	7.89
3/8"	26	1"	3/8"	4	9.48
7/16"	26	1.1/2"	1/2"	5	11.06
1/2"	26	1.1/2"	1/2"	5	12.64
9/16"	26	1.1/2"	1/2"	5	14.23
5/8"	26	1.1/2"	1/2"	5	15.81
3/4"	26	1.1/2"	1/2"	6	18.98

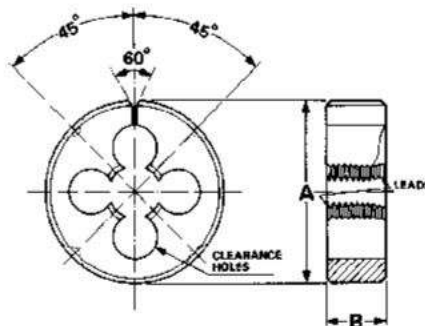

HSS

CS

BS
1127

6G

Unit : mm

Nominal Diameter	TPI	Outer Diameter	Thickness	No. Clearance Hole	Threading Diameter
ØD		A	B		
1/8"	40	13/16"	1/4"	3	3.14
5/32"	32	13/16"	1/4"	3	3.93
3/16"	40	13/16"	1/4"	3	4.72
7/32"	40	13/16"	1/4"	4	5.51
1/4"	40	13/16"	1/4"	4	6.31
1/4"	40	1"	3/8"	4	6.31
9/32"	32	1"	3/8"	4	7.10
5/16"	32	1"	3/8"	4	7.90
3/8"	32	1"	3/8"	4	9.48

ROUND SPLIT DIES

CARBON STEEL

HSS

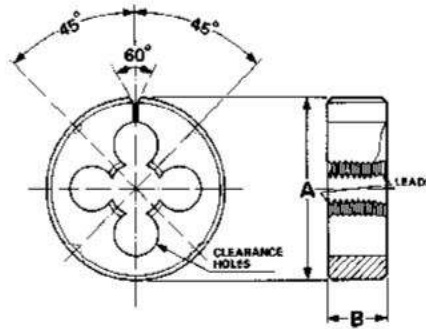

HSS **CS** **BS 1127** **6G**

Unit : mm

Nominal Diameter	TPI	Outer Diameter	Thickness	No. Clearance Hole	Threading Diameter
ØD		A	B		
11/64"	40	13/16"	1/4"	3	4.33
3/16"	28	13/16"	1/4"	3	4.73
13/64"	24	13/16"	1/4"	3	5.13
15/64"	28	13/16"	1/4"	4	5.92
1/4"	32	1"	3/8"	4	6.31
9/32"	40	1"	3/8"	4	7.11
5/16"	40	1"	3/8"	4	7.9
3/8"	40	1"	3/8"	4	9.48
7/16"	40	1.1/2"	1/2"	5	11.07
1/2"	40	1.1/2"	1/2"	5	12.64

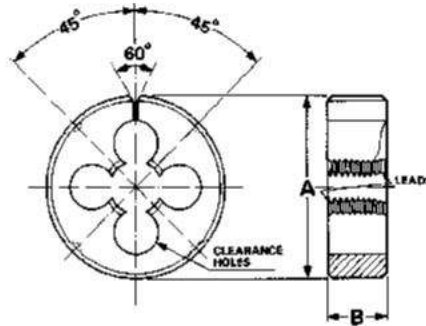

HSS

CS

BS
1127

6G

Unit : mm

Nominal Diameter Ø D	TPI	Outer Diameter	Thickness	No. Clearance Hole	Threading Diameter
		A	B		
1/8"	28	1"	3/8"	4	9.68
1/4"	19	1.1/2"	1/2"	5	13.11
3/8"	19	1.1/2"	1/2"	5	16.6
1/2"	14	1.1/2"	1/2"	6	20.89
1/2"	14	2"	5/8"	5	20.89
5/8"	14	2"	5/8"	6	22.84
3/4"	14	2"	5/8"	6	26.36
7/8"	14	2"	5/8"	6+6	30.11
1"	11	2"	5/8"	6+6	33.16
1.1/8"	11	2.1/2"	7/8"	6	
1.1/4"	11	2.1/2"	7/8"	6	
1.1/4"	11	3"	7/8"	6	
1.3/8"	11	4"	1"		
1.1/2"	11	4"	1"	6	
1.3/4"	11	4"	1"		
2"	11	4"	1"	6	

British Standard Taper Pipe Threads

ROUND SPLIT DIES

CARBON STEEL

HSS

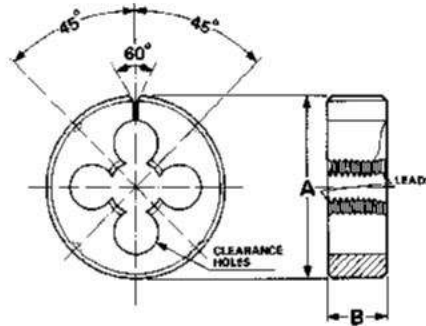

HSS

CS

BS
1127

6G

Unit : mm

Nominal Diameter	TPI	Outer Diameter	Thickness	No. Clearance Hole	Threading Diameter
Ø D		A	B		
1/8"	28	1"	10	4	
1/8"	28	1.1/2"	10	4	
1/4"	19	1.1/2"	14	4	
3/8"	19	1.1/2"	14	5	
3/8"	19	2"	14	5	
1/2"	14	2"	19	5	
3/4"	14	2"	20	6	
3/4"	14	2.1/2"	22	6	
1"	11	2.1/2"	25	6	
1"	11	3"	25	6	
1.1/4"	11	3"	25	6	
1.1/2"	11	4"	25	6	
2"	11	4"	27	6	



Unified Coarse Threads

ROUND SPLIT DIES

CARBON STEEL

HSS

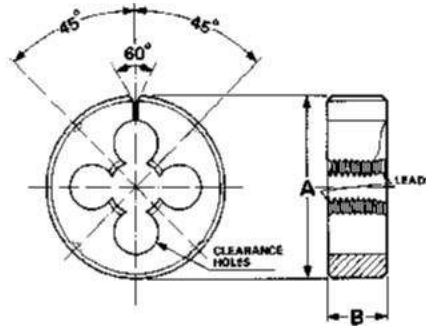

HSS

CS

**BS
1127**

2A

Unit : mm

Nominal Diameter	TPI	Outer Diameter	Thickness	No. Clearance Hole	Threading Diameter
Ø D		A	B		
# 4	40	13/16"	1/4"	3	2.83
# 5	40	13/16"	1/4"	3	3.15
# 6	32	13/16"	1/4"	3	3.48
# 8	32	13/16"	1/4"	3	4.14
# 10	24	13/16"	1/4"	3	4.79
# 12	24	13/16"	1/4"	4	5.45
1/4"	20	13/16"	1/4"	4	6.31
1/4"	20	1"	3/8"	4	6.31
5/16"	18	1"	3/8"	4	7.89
3/8"	16	1"	3/8"	4	9.47
7/16"	14	1.1/2"	1/2"	4	11.05
1/2"	13	1.1/2"	1/2"	4	12.62
9/16"	12	1.1/2"	1/2"	5	14.21
5/8"	11	1.1/2"	1/2"	5	15.79
3/4"	10	1.1/2"	1/2"	6	18.96

Unified Coarse Threads

ROUND SPLIT DIES

CARBON STEEL

HSS

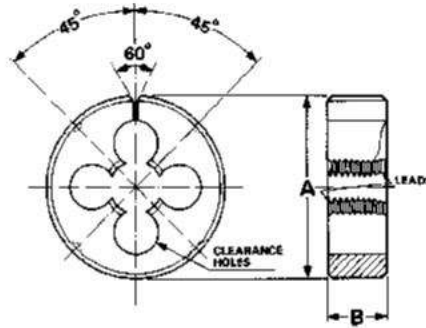

HSS

CS

**BS
1127**

2A

Unit : mm

Nominal Diameter Ø D	TPI	Outer Diameter	Thickness	No. Clearance Hole	Threading Diameter
		A	B		
7/8"	9	2"	5/8"	5	22.14
1"	8	2"	5/8"	6	25.3
1.1/8"	7	2.1/4"	11/16"	6	
1.1/4"	7	2.1/4"	11/16"	6	
1.3/8"	6	2.1/2"	7/8"	6	
1.1/2"	6	2.1/2"	7/8"	6	
1.1/2"	6	3"	7/8"	6	
1.3/4"	5	4"	1"	8	
2"	4.5	4"	1"	6	

ROUND SPLIT DIES

CARBON STEEL

HSS

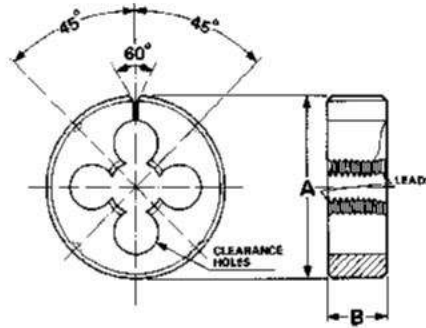

HSS **CS** **BS 1127** **2A**

Unit : mm

Nominal Diameter	TPI	Outer Diameter	Thickness	No. Clearance Hole	Threading Diameter
Ø D		A	B		
# 3	56	13/16"	1/4"	3	
# 4	48	13/16"	1/4"	3	2.83
# 5	44	13/16"	1/4"	3	3.16
# 6	40	13/16"	1/4"	3	3.48
# 8	36	13/16"	1/4"	3	4.14
# 10	32	13/16"	1/4"	3	4.8
# 12	28	13/16"	1/4"	4	5.46
1/4"	28	13/16"	1/4"	4	6.32
1/4"	28	1"	3/8"	4	6.32
5/16"	24	1"	3/8"	4	7.9
3/8"	24	1"	3/8"	4	9.48
7/16"	20	1.1/2"	1/2"	4	11.06
1/2"	20	1.1/2"	1/2"	5	12.65
9/16"	18	1.1/2"	1/2"	5	14.23
5/8"	18	1.1/2"	1/2"	5	15.82
3/4"	16	1.1/2"	1/2"	6	18.99

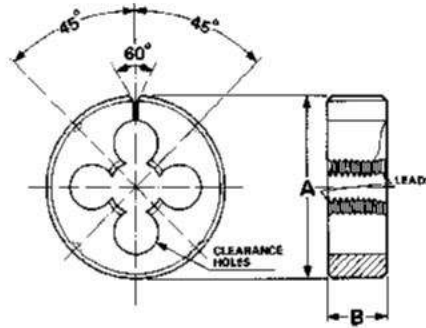

HSS

CS

BS
1127

2A

Unit : mm

Nominal Diameter	Pitch	Outer Diameter	Thickness	No. Clearance Hole	Threading Diameter
Ø D	TPI	A	B		
7/8"	14	2"	5/8"	5	22.13
1"	12	2"	5/8"	6	25.31
1.1/8"	12	2.1/4"	11/16"	6	
1.1/4"	12	2.1/4"	11/16"	6	
1.3/8"	12	2.1/2"	7/8"	6	
1.1/2"	12	2.1/2"	7/8"	6	
1.1/2"	12	3"	7/8"	6	
1.3/4"	14	4"	1"	6	
2"	-	4"	1"	6	

National Taper Pipe Threads

ROUND SOLID DIES

CARBON STEEL

HSS

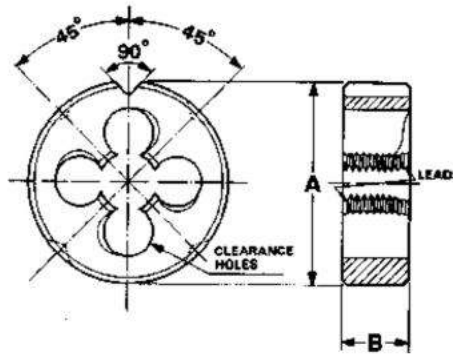

HSS

CS

BS
1127

2A

Unit : mm

Nominal Diameter	TPI	Outer Diameter	Thickness	No. Clearance Hole	Threading Diameter
Ø D		A	B		
1/8"	27	1"	10	4	
1/8"	27	1.1/2"	10	4	
1/4"	18	1.1/2"	15	4	
3/8"	18	1.1/2"	15	5	
3/8"	18	2"	14	5	
1/2"	14	2"	19	5	
3/4"	14	2"	20	6	
3/4"	14	2.1/2"	22	6	
1"	11.1/2	2.1/2"	25	6	
1"	11.1/2	3"	25	6	
1.1/4"	11.1/2	3"	25	6	
1.1/2"	11.1/2	4"	25	6	
2"	11.1/2	4"	27	6	

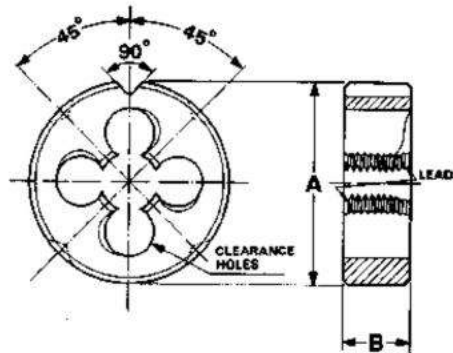

HSS

DIN
22568

6G

Unit : mm

Nominal Diameter Ø D	TPI	Outer Diameter	Thickness	No. Clearance Hole	Threading Diameter
		A	B		
M3	0.5	20	5	3	2.92
M3.5	0.6	20	5	3	3.41
M4	0.7	20	5	3	3.9
M4.5	0.75	20	7	3	4.4
M5	0.8	20	7	3	4.9
M6	1	20	7	4	5.88
M7	1	25	9	4	6.88
M8	1.25	25	9	4	7.86
M9	1.25	25	9	4	8.86
M10	1.5	30	11	4	9.85
M11	1.5	30	11	4	10.85
M12	1.75	38	14	4	11.83
M14	2	38	14	4	13.82
M16	2	45	18	5	15.82
M18	2.5	45	18	5	17.79
M20	2.5	45	18	5	19.79
M22	2.5	55	22	5	21.79
M24	3	55	22	5	23.76

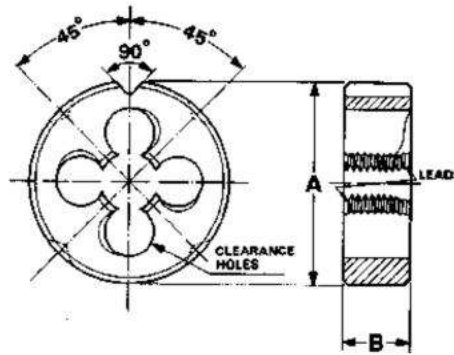

HSS

DIN
22568

6G

Unit : mm

Nominal Diameter	TPI	Outer Diameter	Thickness	No. Clearance Hole	Threading Diameter
Ø D		A	B		
M3.5	0.6	20	5	3	3.43
M4	0.5	20	5	4	3.92
M4.5	0.5	20	5	4	4.43
M5	0.5	20	5	4	4.92
M5	0.75	20	5	4	4.91
M5.5	0.75	20	7	4	5.43
M6	0.5	20	7	4	5.92
M6	0.75	20	7	4	5.9
M7	0.75	25	9	4	6.9
M8	0.5	25	9	4	7.92
M8	0.75	25	9	4	7.9
M8	1	25	9	4	7.88
M9	0.75	25	9	4	8.9
M9	1	25	9	4	8.88
M10	0.75	30	11	4	9.9
M10	1	30	11	5	9.88
M10	1.25	30	11	4	9.86
M11	0.75	30	11	5	10.91
M11	1	30	11	4	10.88
M12	1	38	10	4	11.88
M12	1.25	38	10	4	11.86
M12	1.5	38	10	4	11.85
M14	1	38	10	5	13.88

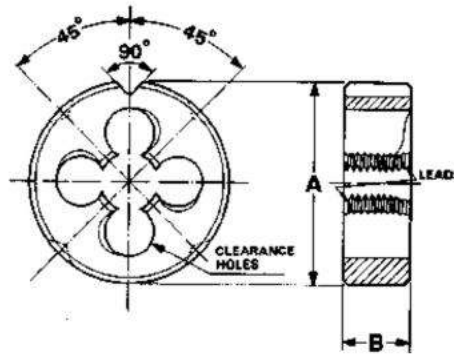

HSS

DIN
22568

6G

Unit : mm

Nominal Diameter	TPI	Outer Diameter	Thickness	No. Clearance Hole	Threading Diameter
Ø D		A	B		
M14	1.5	38	10	5	13.85
M15	1	38	10	5	14.88
M15	1.5	38	10	5	14.85
M16	1	45	14	5	15.88
M16	1.5	45	14	5	15.85
M17	1	45	14	5	16.88
M17	1.5	45	14	5	16.85
M18	1	45	14	5	17.88
M18	1.5	45	14	5	17.85
M18	2	45	14	5	17.82
M20	1	45	14	6	19.8
M20	1.5	45	14	6	19.85
M20	2	45	14	6	19.82
M22	1	55	16	6	21.88
M22	1.5	55	16	6	21.85
M22	2	55	16	6	21.82
M24	1	55	16	6	21.88
M24	1.5	55	16	6	23.85
M24	2	55	16	6	23.82
M25	1	55	16	6	24.88
M25	1.5	55	16	6	24.85
M25	2	55	16	6	24.82
M26	1.5	55	16	6	25.85

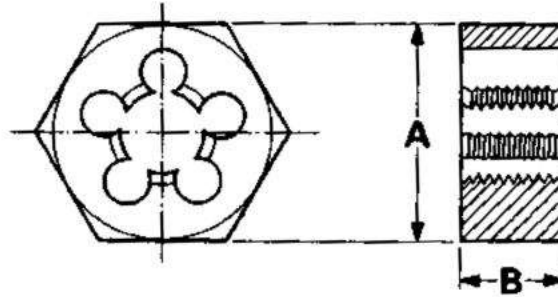

HSS

CS

BS
1127

6G

Unit : mm

Nominal Diameter	Pitch	Across Flat	Thickness
Ø D	P	A	
M 2	0.4	0.710"	6.35
M 2.5	0.45	0.710"	6.35
M 3	0.5	0.710"	6.35
M 4	0.7	0.710"	6.35
M 5	0.8	0.710"	6.35
M 6	1	0.710"	6.35
M 7	1	0.710"	6.35
M 8	1.25	0.820"	7.94
M 9	1.25	0.920"	9.53
M 10	1.5	0.920"	9.53
M 12	1.75	1.100"	12.70
M 14	2	1.300"	15.88
M 16	2	1.300"	15.88
M 18	2.5	1.480"	17.46
M 20	2.5	1.480"	17.46
M 22	2.5	1.670"	20.63
M 24	3	2.050"	23.81
M 27	3	2.220"	26.99
M 30	3.5	2.220"	26.99
M 36	4	2.760"	31.75
M 39	4	2.760"	31.75
M 42	4.5	3.150"	31.75 44.45
M 45	4.5	3.150"	31.75 44.45
M 48	5	3.150"	31.75 44.45

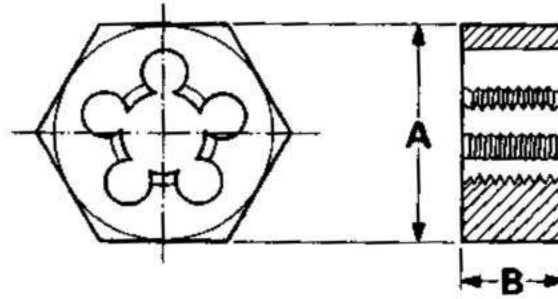

HSS

CS

BS
1127

6G

Unit : mm

Nominal Diameter	Pitch	Across Flat	Thickness
Ø D	p	A	
M 3	0.6	0.710"	6.35
M 3.5	0.6	0.710"	6.35
M 4	0.75	0.710"	6.35
M 5	0.5	0.710"	6.35
M 6	0.75	0.710"	6.35
M 7	1	0.710"	6.35
M 8	1	0.820"	7.94
M 9	1.25	0.920"	9.53
M 10	1	0.920"	9.53
M 10	1.25	0.920"	9.53
M 11	1.5	1.010"	11.11
M 12	1	1.100"	12.70
M 12	1.25	1.100"	12.70
M 12	1.5	1.100"	12.70

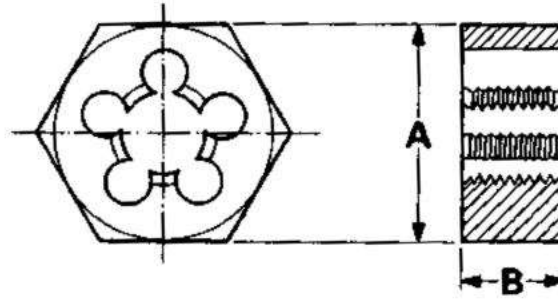

HSS

CS

BS
1127

6G

Unit : mm

Nominal Diameter	Pitch	Across Flat	Thickness
Ø D	p	A	
M 14	1.25	1.300"	15.88
M 14	1.5	1.300"	15.88
M 16	1.5	1.300"	15.88
M 18	1.5	1.480"	17.46
M 20	1.5	1.480"	17.46
M 22	1.5	1.670"	20.63
M 24	1.5	2.050"	23.81
M 25	1.5	2.220"	26.99
M 27	1.5	2.220"	26.99
M 27	2	2.220"	26.99
M 30	1.5	2.220"	26.99
M 30	2	2.220"	26.99
M 30	3	2.220"	26.99
M 32	1.5	2.220"	26.99
M 33	3.5	2.580"	28.58

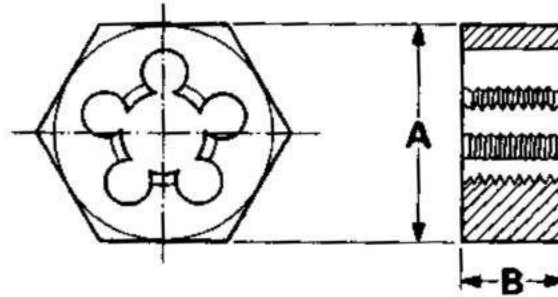

HSS

CS

BS
1127

6G

Unit : mm

Nominal Diameter	TPI	Across Flat	Thickness
Ø D		A	
1/8"	40	0.710"	6.35
5/32"	32	0.710"	6.35
3/16"	24	0.710"	6.35
7/32"	24	0.710"	6.35
1/4"	20	0.710"	6.35
9/32"	20	0.820"	7.94
5/16"	18	0.820"	7.94
3/8"	16	0.920"	9.53
7/16"	14	1.010"	11.11
1/2"	12	1.100"	12.70
9/16"	12	1.300"	15.88
5/8"	11	1.300"	15.88
3/4"	10	1.480"	17.46
7/8"	9	1.670"	20.63
1"	8	2.050"	23.81
1.1/8"	7	2.220"	26.99
1.1/4"	7	2.220"	26.99
1.3/8"	6	2.580"	28.58
1.1/2"	6	2.760"	31.75
1.3/4"	6	3.150"	31.75 44.45
2"	4.1/2	3.550"	31.75 44.45

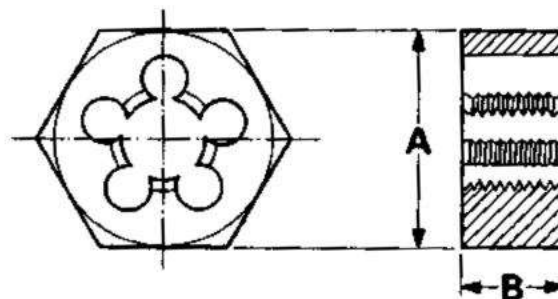

HSS

CS

BS
1127

6G

Unit : mm

Nominal Diameter	TPI	Across Flat	Thickness
Ø D		A	
3/16"	32	0.710"	6.35
7/32"	28	0.710"	6.35
1/4"	26	0.710"	6.35
5/16"	22	0.820"	7.94
3/8"	20	0.920"	9.53
7/16"	18	1.010"	11.11
1/2"	16	1.100"	12.70
9/16"	16	1.300"	15.88
5/8"	14	1.300"	15.88
3/4"	12	1.480"	17.46
7/8"	11	1.670"	20.63
1"	10	2.050"	23.81

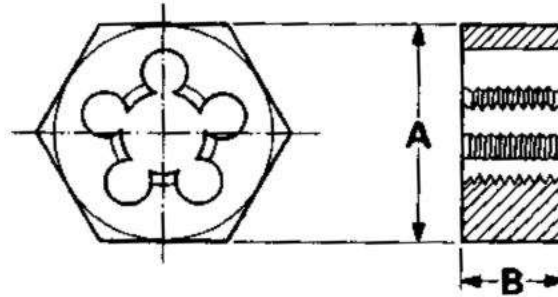

HSS

CS

BS
1127

6G

Unit : mm

Nominal Diameter	TPI	Across Flat	Thickness
ØD		A	
1/8"	28	0.920"	9.53
1/4"	19	1.100"	12.70
3/8"	19	1.300"	15.88
1/2"	14	1.670"	20.63
5/8"	14	1.670"	20.63
3/4"	14	2.050"	23.81
7/8"	14	2.220"	26.99
1"	11	2.580"	28.58
1.1/4"	11	2.760"	31.75
1.1/2"	11	3.150"	31.75 44.45
2"	11	3.890"	31.75 44.45

HEXAGONAL DIES

CARBON STEEL

HSS

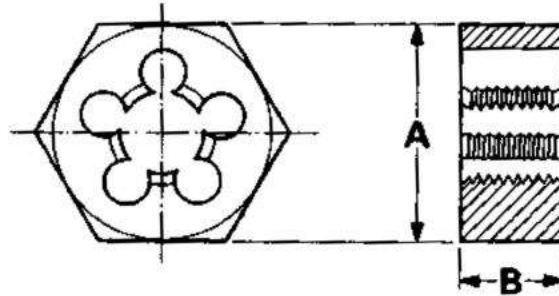

HSS

CS

BS
1127

6G

Unit : mm

Nominal Diameter	TPI	Across Flat	Thickness
ØD		A	
1/8"	28	0.920"	10
1/4"	19	1.100"	14
3/8"	19	1.300"	14
1/2"	14	1.670"	19
3/4"	14	2.050"	20
1"	11	2.580"	25

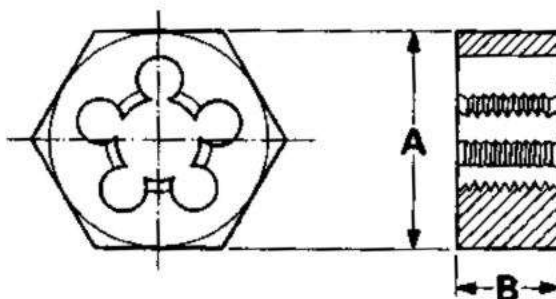

HSS

CS

BS
1127

2A

Unit : mm

Nominal Diameter Ø D	TPI	Across Flat	Thickness
		A	
# 5	40	0.710"	6.35
# 6	32	0.710"	6.35
# 8	32	0.710"	6.35
# 10	24	0.710"	6.35
# 12	24	0.710"	6.35
1/4"	20	0.710"	6.35
5/16"	18	0.820"	7.94
3/8"	16	0.920"	9.53
7/16"	14	1.010"	11.11
1/2"	13	1.100"	12.70
9/16"	12	1.300"	15.88
5/8"	11	1.300"	15.88
3/4"	10	1.480"	17.46
7/8"	9	1.670"	20.63
1"	8	2.050"	23.81
1.1/8"	7	2.220"	26.99
1.1/4"	7	2.220"	26.99
1.3/8"	6	2.580"	28.58
1.1/2"	6	2.760"	31.75

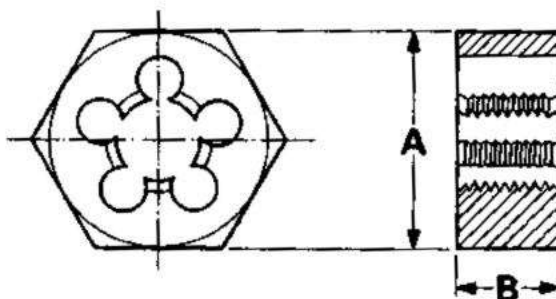

HSS

CS

BS
1127

2A

Unit : mm

Nominal Diameter Ø D	TPI	Across Flat	Thickness
		A	
# 5	44	0.710"	6.35
# 6	40	0.710"	6.35
# 8	36	0.710"	6.35
# 10	32	0.710"	6.35
# 12	28	0.710"	6.35
1/4"	28	0.710"	6.35
5/16"	24	0.820"	7.94
3/8"	24	0.920"	9.53
7/16"	20	1.010"	11.11
1/2"	20	1.100"	12.70
9/16"	18	1.300"	15.88
5/8"	18	1.300"	15.88
3/4"	16	1.480"	17.46
7/8"	14	1.670"	20.63
1"	12	2.050"	23.81
1.1/8"	12	2.220"	26.99
1.1/4"	12	2.220"	26.99
1.3/8"	12	2.580"	28.58
1.1/2"	12	2.760"	31.75

National Taper Pipe Threads

HEXAGONAL DIES

CARBON STEEL

HSS

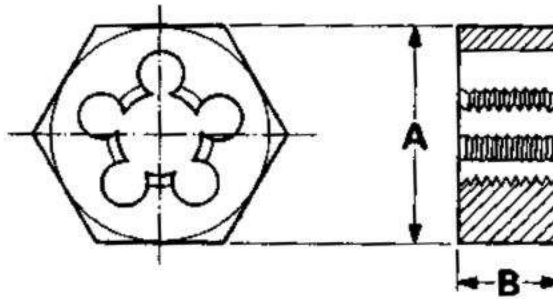

HSS

CS

BS
1127

2A

Unit : mm

Nominal Diameter	TPI	Across Flat	Thickness
ØD		A	
1/8"	27	0.920"	10
1/4"	18	1.100"	15
3/8"	18	1.300"	15
1/2"	14	1.670"	19
3/4"	14	2.050"	20
1"	11.1/2	2.580"	25
1.1/2"	11.1/2	3.150"	
2"	11.1/2	3.890"	

DIC – INDIA
DEDICATED IMPEX CO.

D – 189, Industrial Focal Point, Patiala
147003 Punjab, India
info@dictoolsindia.com
+91-95922-28222

DIC – UAE
DEDICATED IMPEX FZE

B.C. 1303260, Ajman Free Zone,
P.O. BOX: 47359, Ajman, UAE
info@dictoolsindia.com
(+971) 556721577

DiCTOOLS

A Brand by Dedicated Impex Co.